

ADDITIONAL PEDESTRIAN RIGHTS OF WAY FOOTPATH

- - - 1800mm high treated feather edge timber fencing all set within inside of car park and tree line. Entrance security gates to be locked at night
- wall mounted security cameras
- lamppost with lighting & security cameras all set within inside of car park and tree line
- lamppost with lighting all set within inside of car park and tree line

**THE CUE CLUB (COVENTRY) LIMITED**  
 Wayside House, Watling St, Burbage, Leicestershire, LE10 3JA

DRAWN	BAL
SCALE	1.500@A4
DATE	23.09.2023
DRAWING NUMBER	LD1 (PAGE 1)
REVISION	1st FOR LICENSING
REV.DATE	
DRAWING TYPE	

The Cue Club  
 Kenpas Hall, Kenpas Highway  
 Coventry, CV3 6AW

**SITE LAYOUT**

VEHICLE ACCESS ROUTE

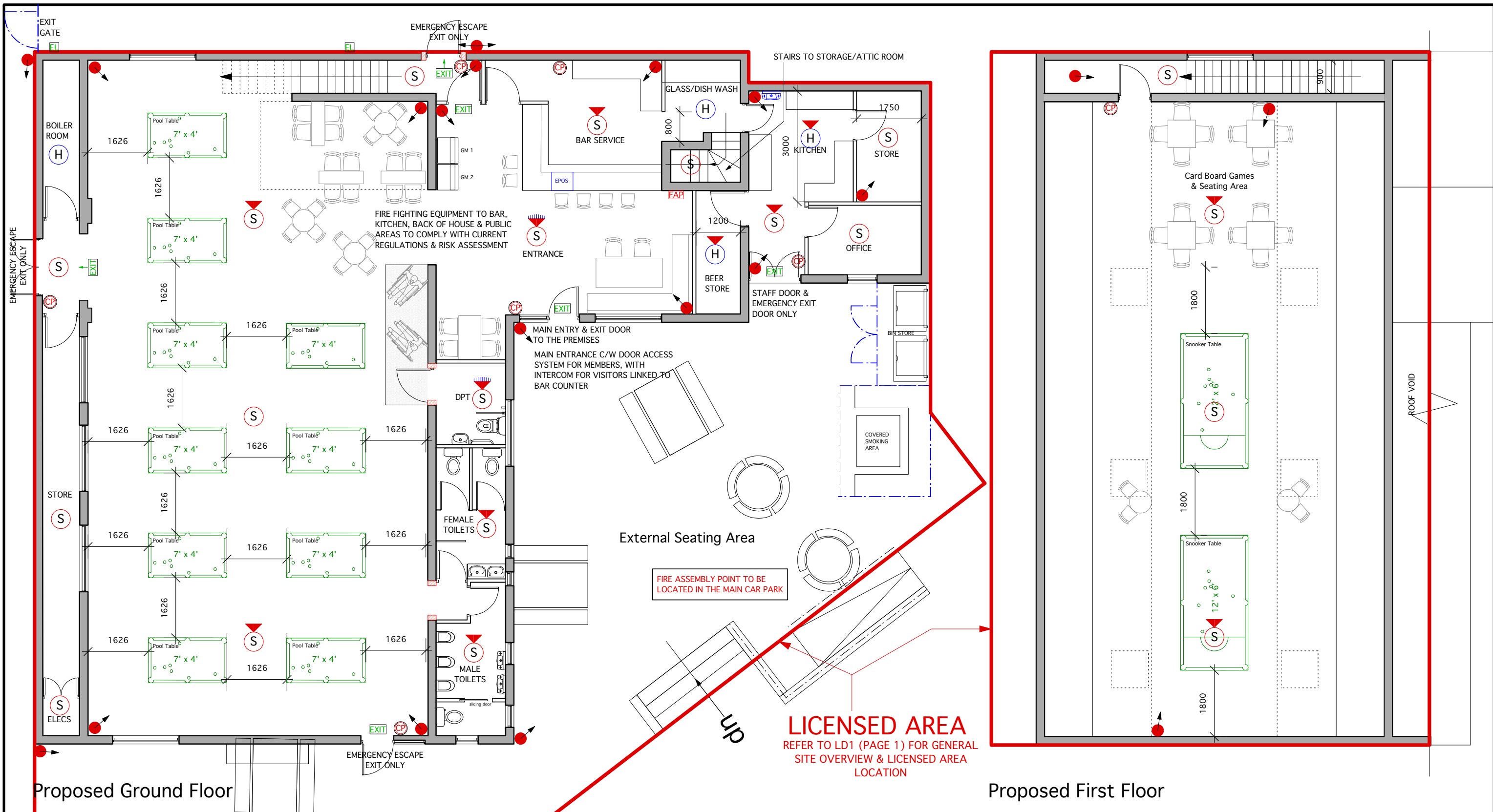

Proposed Ground Floor

Proposed First Floor

**LICENSED AREA**  
 REFER TO LD1 (PAGE 1) FOR GENERAL  
 SITE OVERVIEW & LICENSED AREA  
 LOCATION

FIRE ASSEMBLY POINT TO BE  
 LOCATED IN THE MAIN CAR PARK

	FIRE ALARM PANEL	<b>NOTES</b> 1. FIRE ALARM SYSTEM TO A BS 5839-1 CATEGORY L1. SYSTEM TO BE LINKED TO A MONITORING SERVICE 2. EMERGENCY LIGHTING AND EXIT LIGHTING TO BS 5266 THROUGHOUT. EXIT LIGHTS ONLY SHOWN AT THIS STAGE FOR LICENSING PURPOSES 3. CCTV SYSTEM TO COVER ALL AREAS AS SHOWN WITH RECORDING HARD DRIVE. SYSTEM TO BE LINKED TO OFF SITE MANAGERIAL STAFF 4. AS A MEMBERS CLUB ENTRANCE BY WAY OF DOOR ACCESS FOB SYSTEM WITH INTERCOM FOR VISITORS LINKED TO BAR / STAFF AREA 5. EMERGENCY EXIT ROUTES AS SHOWN WITH FIRE ASSEMBLY POINT IN CAR PARK 6. FIRE RATED LOBBY AT BOTTOM OF STAIRS FOR EXIT ROUTE FROM 1ST FLOOR 7. INTRUDER ALARM SYSTEM FITTED THROUGHOUT LINKED TO A MONITORING SERVICE 8. FIRE FIGHTING EQUIPMENT TO BAR, KITCHEN, BACK OF HOUSE & PUBLIC AREAS TO COMPLY WITH CURRENT REGULATIONS & RISK ASSESSMENT 9. BACK GROUND MUSIC SYSTEM TO BE INSTALLED 10. LIVE & RECORDED MUSIC SYSTEM EQUIPMENT TO BE USED FOR EVENTS, LOCATIONS EVENT SPECIFIC
	FIRE ALARM CALL POINT	
	SMOKE DETECTOR	
	SMOKE DETECTOR/SOUNDER	
	SMOKE DETECTOR/SOUNDER/FLASHER	
	HEAT DETECTOR	
	HEAT DETECTOR/SOUNDER	
	CCTV CAMERA	
	ILLUMINATED EXIT SIGN WITH DIRECTIONAL ARROW ← IF REQUIRED	
	EMERGENCY LIGHT	
	TILL LOCATION	
	GAMING MACHINE	

<b>THE CUE CLUB (COVENTRY) LIMITED</b> Wayside House, Watling St, Burbage, Leicestershire, LE10 3JA		
DRAWN	BAL	The Cue Club Kenpas Hall, Kenpas Highway Coventry, CV3 6AW <b>PROPOSED LAYOUT</b>
SCALE	1:100@A3	
DATE	23.09.2023	
DRAWING NUMBER	LD1 (PAGE 2)	
REVISION	1st FOR LICENSING	
REV.DATE		
DRAWING TYPE		